

THREADED PLUG INSTRUCTIONS

M68030
REV. A1

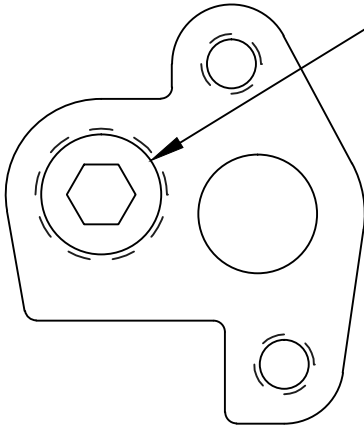

PLUG MUST BE FLUSH
OR BELOW SURFACE

IMPORTANT

AFTER TURNING THREADED PLUG
IN OR OUT OF VALVE HOLE,
CHECK HOUSING TO MAKE
SURE PLUG IS FLUSH OR
BELOW FINISHED SURFACE,
AS SHOWN IN ILLUSTRATION.

CAUTION! IF PLUG IS NOT FLUSH,
THE SCREEN WILL BE COCKED
CAUSING ENGINE DAMAGE.

(A1)

SHEET SIZE : 4 1/2" x 3 1/4"

A1	1/29/14	REMOVED 10687/10688 PUMP #'S	4007
	2/23/98	RELEASED	1800
LTR.	DATE	REVISIONS	ECR #

MELLING TOOL COMPANY



ENGINE COMPONENTS
PRODUCT ENGINEERING



REF. M68	SHT.	OF
DRAWN BY	COMPLETED	CHECKED
R.G.J.	2/23/98	
APPROVED	SCALE	

NAME

SHEET-PLUG INSTRUCTION

PART NO. M68030